

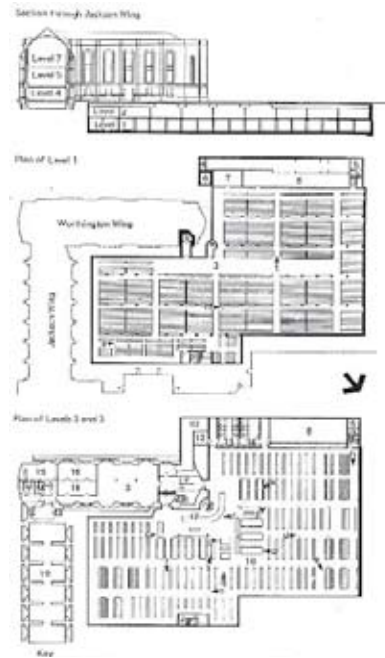

OXFORD UNIVERSITY, RADCLIFFE SCIENCE LIBRARY, OXFORD

Pringle Richards Sharratt were appointed by Oxford University to carry out an appraisal of the existing Radcliffe Science Library's accommodation, to determine its potential capacity to house future expansion and the Geography Library. The study looked at both short and long term solutions. The short term solutions/requirements until Summer 2007 highlighted the following issues:

- Increased capacity through omitting reader spaces.
- Disabled access.
- The Introduction of the Geography Library into the building.
- Additional open access shelving.
- Sufficient spare capacity to cater for future expansion until Summer 2007.



**Oxford University**  
£2.4 million  
2004-2007